



 paulwallace

Turners Hill, Cheshunt, EN8 8LQ |  
£225,000 | Leasehold

## Turners Hill, Cheshunt, EN8 8LQ

**\*\* CHAIN-FREE\*\*** A ONE BEDROOM flat in STUNNING CONDITION, by the OLD POND in Cheshunt, offering a LONG LEASE, an immaculate and modern KITCHEN, FITTED BATHROOM, and spacious lounge/dining room. The property is well situated for local amenities and walking distance of both Cheshunt and Theobalds Grove Train Stations.

### Key features

- One Bedroom Upper Floor Flat
- Stunning Condition Throughout
- Modern Kitchen & Bathroom
- Large Lounge/Diner
- Beautiful Bathroom
- Secure Communal Entrance
- Lease 118 Years
- Annual Service Charge £1,600

### Property Information

Tenure

Leasehold

Council Tax

B

EPC Rating

B

Local Authority

Broxbourne Borough Council

Lease Length

118

Annual Service Charge, incl. Ground Rent

£1,600



**Paul Wallace Estate Agents**  
Brookfield Centre  
Cheshunt  
Hertfordshire  
EN8 0NN



01992 781100



cheshunt@paulwallace.co.uk



www.paulwallace.co.uk



Opening Times

Mon - Fri	9 am to 6:30 pm
Sat	9 am to 5:30 pm
Sun	Closed
Bank Hols	Closed

**paulwallace**  
estate agents

Cheshunts leading estate agent.  
Please get in touch for your free  
property valuation.





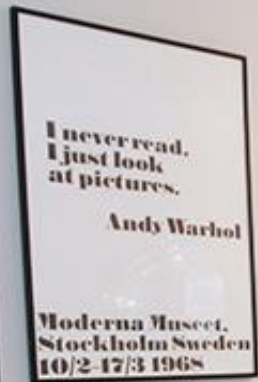





## SECOND FLOOR

463 sq.ft. (43.1 sq.m.) approx.

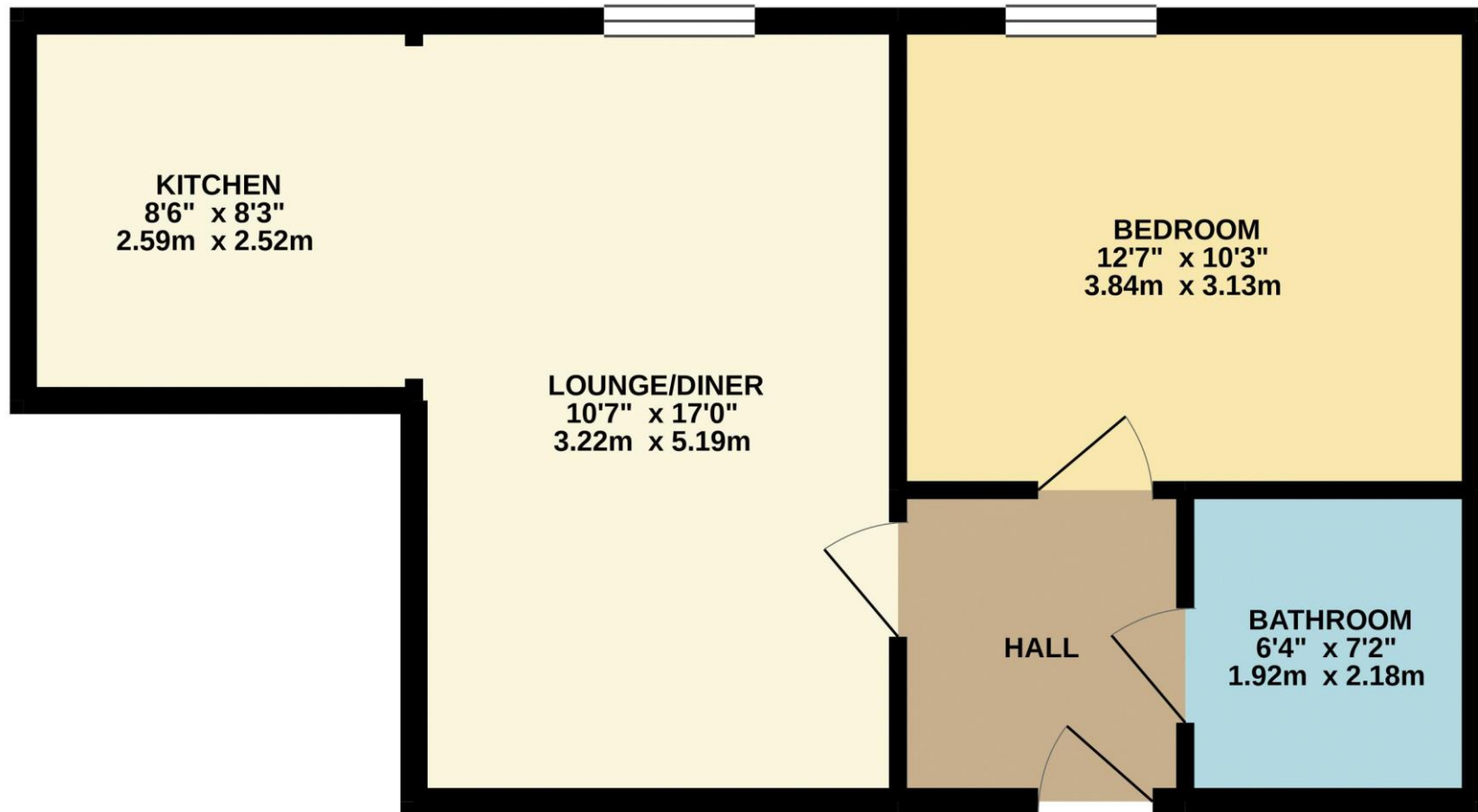

TOTAL FLOOR AREA : 463 sq.ft. (43.1 sq.m.) approx.

Whilst every attempt has been made to ensure the accuracy of the floorplan contained here, measurements of doors, windows, rooms and any other items are approximate and no responsibility is taken for any error, omission or mis-statement. This plan is for illustrative purposes only and should be used as such by any prospective purchaser. The services, systems and appliances shown have not been tested and no guarantee as to their operability or efficiency can be given.

Made with Metropix ©2021



